

Paul Gothe GmbH
2 Cylinder diaphragm pump for gas sampler 26.021-CP(P-722)

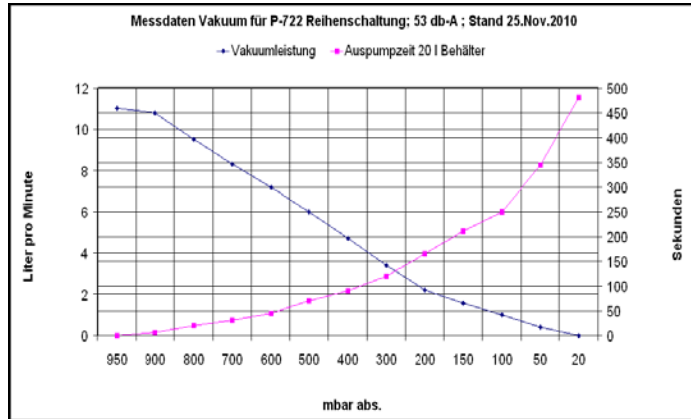
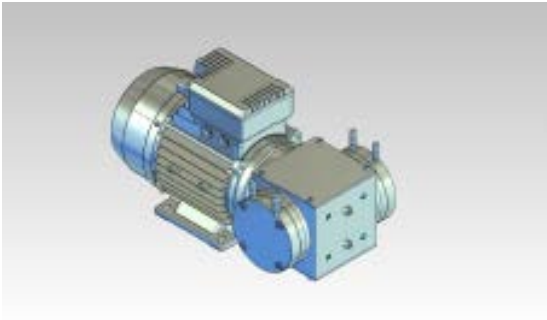
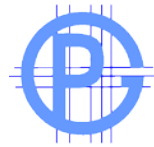

Pneumatic Performance

Suction performance at 20°C	In series 11,5 l/min
Max. vacuum in mbar/abs.	In series up to 20 mbar abs.
Pressure against atmospheric	0,5 Bar does not exceed
Number of cylinders	2
Pneumatic connections	Hose nozzles

Electrical supply ratings of engine

Engine power (AC~);Upm	120 W; 220-240V~50Hz; 1360Upm 1 phase alternating current
Current consumption I	0,96 A
TH-C1 / protection	F / IP 55

General information

Acceptable gas inlet temperature	+ 5°C ... + 45°C
Acceptable ambient temperature	+10°C ... + 45°C
Sizes L x B x H	265mm x 120mm x 155mm
Weight ca.	4,6 kg

Material

Pump heads and chambers Aluminium; ventile FKM; O-rings EPDM; membrane FKM; washer Alu

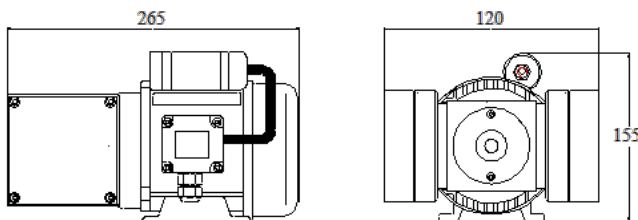

Pump type: P-722/W

Paul Gothe GmbH
 Wittener Str. 82 • D-44789 Bochum
 Tel.: +49 (0)234-335180
 Fax: +49 (0)234-308217

web: www.paulgothe.com •
 eMail: info@paulgothe.de

Membrane-; O-Ring-; valve changing

1.
Remove any pump tubing. Make notes that you remember the connectors.

2.



Mark position from cover and chamber.

3.

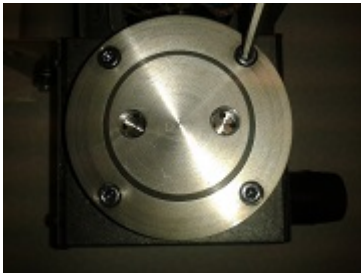

Loosen the Allen screws and remove cover.

4.

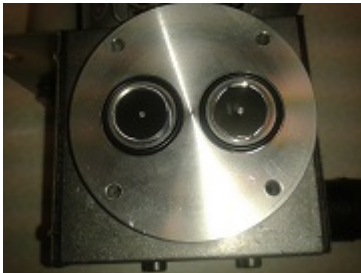

Remove chamber.

5.



Lose diaphragm clamping disc with screw driver.

6.



Take off diaphragm clamping disc with membranes (2 pieces), and possible leveling washer.

7.



Membrane set (black membrane 2 pieces) remove and dispose.

8.



Use new membrane set.

Place the new membrane that the three holes are installed together in an offset manner and only the middle hole is completely open.

9.

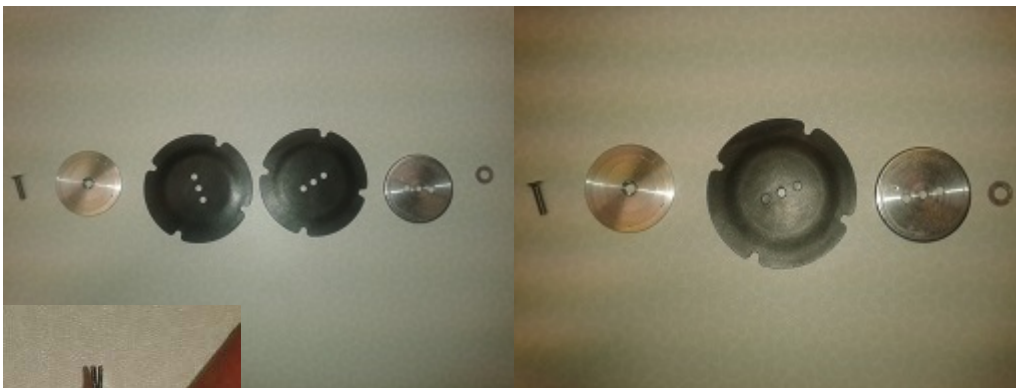

Place screw, clamping disc (with lowered central hole), membrane set, support plate (place with slanted site on membrane set) and possible leveling washer as shown on picture.

Result.

10.

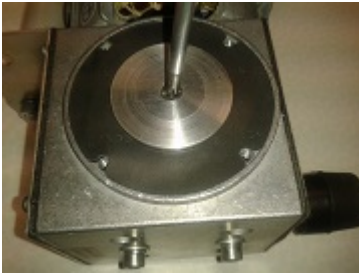

Place complete set again.

Pay attention that the recesses from the membranes are over the threads for the fixing of the chamber and head.

11.

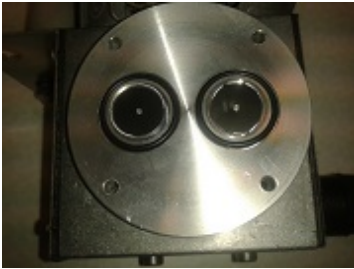

Place pump chamber with new O-Ring and butterfly valves and have a look to your markings from picture 2.

12.



Place cover, and have a look to your markings from picture 2.
Insert hexagon socket head screws and tighten with the hexagonal key.

13.

Place all hoses again on the pump heads.